

1 x Right Panel  
1 x Back Panel

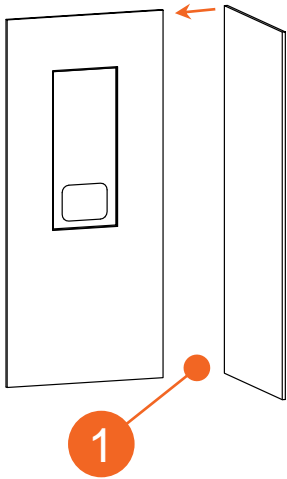

Connect Right Panel to Back Panel

1 x Left Panel

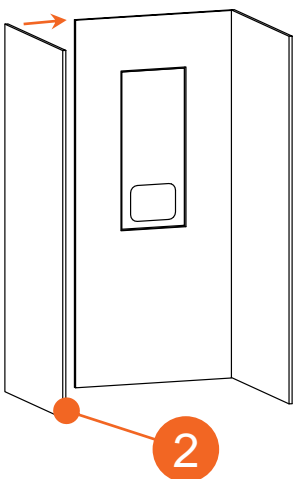

Connect Left Panel to Back Panel

1 x Top Shelf

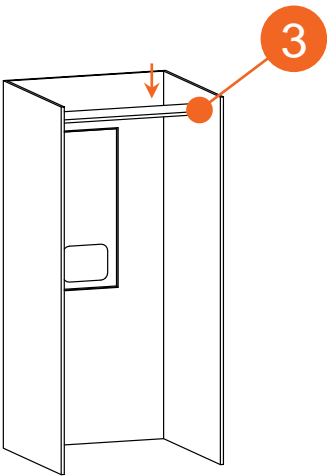

Add Top Shelf, connecting it to all 3 sides of the booth

1 x Worktop

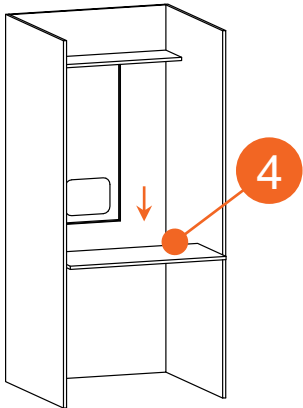

Add Worktop, connecting it to all 3 sides of the booth

1 x Shelf

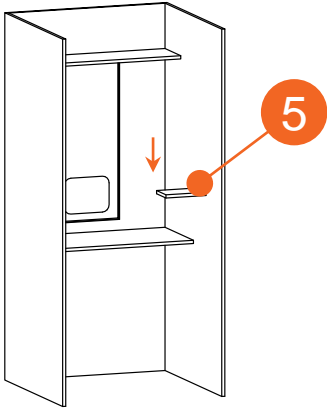

Add Shelf, connecting it to the 2 sides of the booth

1 x Header Panel

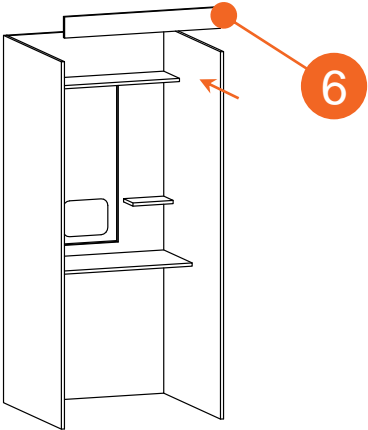

Add Header Panel, connecting it to the Left & Right Panel.  
Place Glove Box Holder left of window, inside.

Stand-alone Booth & Desk B9201  
Instruction Manual

15/01/21

- Stand-alone Parts List:
- |                 |                      |
|-----------------|----------------------|
| 1 x Left Panel  | 1 x Top Shelf        |
| 1 x Right Panel | 1 x Shelf            |
| 1 x Back Panel  | 1 x Worktop          |
|                 | 1 x Glove Box Holder |



Tel: 0800 980 0192  
Email: [sales@hbsgroup.net](mailto:sales@hbsgroup.net)  
[www.hbsgroup.net](http://www.hbsgroup.net)  
©2021 HBS Group. All Rights Reserved  
Unit 8, Easter Park, Axial Way, Mile End, Colchester CO4 5WY

